

- GENERAL NOTES:**
- ANY QUERIES OR DISCREPANCIES ARE TO BE REFERRED TO THE ENGINEER IMMEDIATELY.
 - WORKS TO BE CARRIED OUT IN ACCORDANCE WITH ALL RELEVANT AUTHORITIES AND CONTRACT REQUIREMENTS.
 - ALL CO-ORDINATES ARE TO IRISH NATIONAL GRID.
 - TRAFFIC MANAGEMENT PLAN IS IN ACCORDANCE WITH
 - GUIDANCE FOR THE CONTROL & MANAGEMENT OF TRAFFIC AT ROADWORKS (2ND EDITION 2010).
 - DEPARTMENT OF TRANSPORT TRAFFIC SIGNS MANUAL CHAPTER 8 & TRAFFIC SIGNS MANUAL (2010).
 - LOT 3, DESIGN PROCESS TRAFFIC MANAGEMENT PLAN.
 - EXISTING STATUTORY SIGNS SHALL BE PROTECTED IF THEY DO NOT CONFLICT WITH PROPOSED SIGNAGE. OTHERWISE STATUTORY SIGNS SHOULD BE COVERED OR TEMPORARILY RELOCATED.
 - ALL REQUIRED SITE ACCESS AND EXITS TO BE IDENTIFIED, ALLOCATED, CLEARLY SIGNED & MARKED ON SITE. CONSTRUCTION TRAFFIC TO BE ALLOWED TO ACCESS OR EXIT THE SITE WHEN SAFE TO DO SO (MUST JOIN END OF A STREAM OF TRAFFIC WHEN EXITING).
 - T.M. INSTALLED AS PER TABLE AND DESIGN PARAMETERS BELOW.
 - 600mm DIAMOND WARNING SIGNS AND 600mm CIRCULAR SIGNS TO BE USED.
 - ENTRY AND EXIT TAPERS @ 45 DEGREES WITH CONES AT 1m CENTRES.
 - WHERE THE ROAD REINSTATEMENT IS TEMPORARY OR UNFINISHED, THE FOLLOWING SIGNAGE SHALL BE IN PLACE ONCE SHUTTLE SYSTEM IS REMOVED
 - SIGN 'SLIPPERY SURFACE' (WK072) WITH SUPPLEMENTARY PLATE 'UNFINISHED ROAD SURFACE' (P085) WILL BE ERECTED WHERE SIGNS 'TEMPORARY TRAFFIC SIGNALS' (WK080) WERE LOCATED TO WARN MOTORISTS.
 - SIGNS 'ROADWORKS AHEAD' (WK001) AND 'ROADWORKS AHEAD' (WK001) WITH SUPPLEMENTARY PLATE 'END' (P010) SHALL REMAIN IN PLACE FOR THIS PERIOD.

- DESIGN PARAMETERS:**
- ROAD WORKS TYPE B (PART TIME) TRAFFIC MANAGEMENT.
 - SPEED LIMIT = 50 km/h. SINGLE CARRIAGEWAY ROAD.
 - LEVEL 2 ROAD CLASSIFICATION

- LEGEND:**
- Proposed Road Closure (Two Phases)
 - Traffic Cones
 - Sign Location and Orientation
 - Pedestrian Barriers
 - Diversion Route
 - Diversion Route

Design Parameters	Roadworks Type A (Full-Time)	Roadworks Type B (Part-Time)	Roadworks Type C (Short Duration)
Speed Limit	50 or 60 km/h	50 or 60 km/h	50 or 60 km/h
Temporary Signs			
Sign Visibility (m)	50	50	50
Number of Signs	3	3	2
Cumulative Distance (m)	75	75	50
Distance between advance signs (m)	25	25	25
Minimum Rate of Taper			
Taper at Lane (m)	1 in 15	1 in 5	1 in 5
Taper at Hard Shoulder (m)	1 in 10	1 in 5	1 in 5
Maximum Lamp Spacing			
At Taper (m)	6	6	6
Longitudinal (m)	12	12	12
Maximum Cone Spacing			
At Tapers (m)	3	3	3
Longitudinal (m)	6	6	6
Cone Height (mm)	1000	1000	1000
Safety Zone			
Longitudinal (m)	25	5	5
Lateral (m)	0.5	0.5	0.5
Minimum Lane Width			
Min Lane Width (m)	3.0	3.0	3.0

REV	DATE	DESCRIPTION	DESIGNED BY	CHECKED BY	DATE
0	5/Aug/17	Initial Release for Construction	SM	SM	CG

WARD & BIRKE GROUP LIMITED

Stradbally East, Kilsigan, Co. Galway, Ireland
 Direct: +353 (0)91 796877
 Fax: +353 (0)91 776828
www.wardandbirke.com

Client:	IRISH WATER/ CORK COUNTY COUNCIL	Project No.:	C557
Project Title:	CORK LOWER HARBOUR - LOT 2 ESB DUCTING WORKS	Drw No.:	WB-PT-LL-002
Drawing Title:	L-2481-0 ROAD CLOSURE	Revision:	0
		Scale:	1:500

DIVERSION

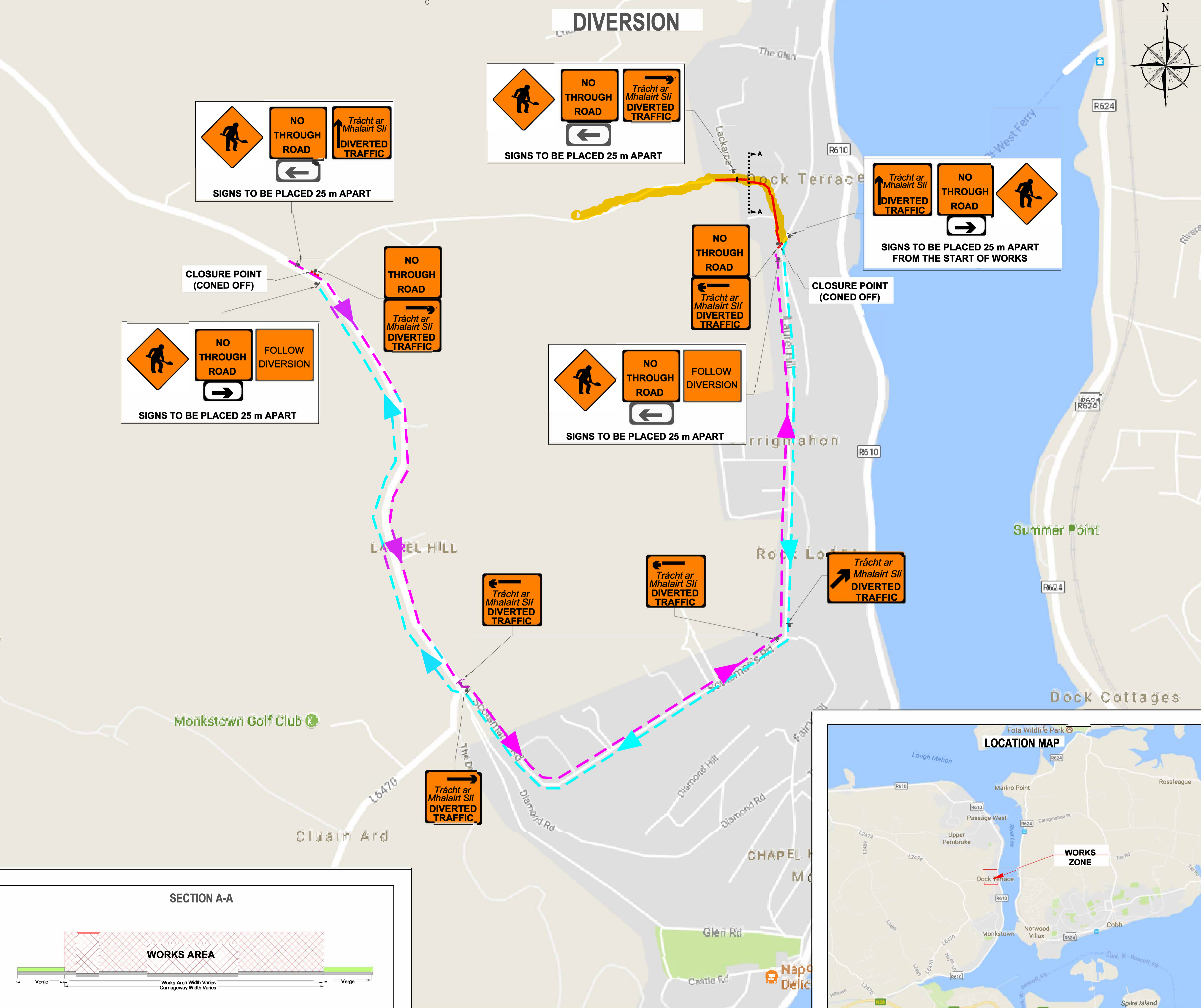

SIGNS TO BE PLACED 25 m APART

- NO THROUGH ROAD (Left Arrow)
- Trácht ar Mhalairt Sli DIVERTED TRAFFIC (Up Arrow)

SIGNS TO BE PLACED 25 m APART

- NO THROUGH ROAD (Left Arrow)
- Trácht ar Mhalairt Sli DIVERTED TRAFFIC (Right Arrow)

SIGNS TO BE PLACED 25 m APART FROM THE START OF WORKS

- Trácht ar Mhalairt Sli DIVERTED TRAFFIC (Up Arrow)
- NO THROUGH ROAD (Right Arrow)
- Trácht ar Mhalairt Sli DIVERTED TRAFFIC (Right Arrow)

SIGNS TO BE PLACED 25 m APART

- NO THROUGH ROAD (Right Arrow)
- FOLLOW DIVERSION (Right Arrow)

SIGNS TO BE PLACED 25 m APART

- NO THROUGH ROAD (Left Arrow)
- FOLLOW DIVERSION (Left Arrow)

CLOSURE POINT (CONED OFF)

CLOSURE POINT (CONED OFF)

