

Figure 1

Legend

Existing Network

Existing Combined Sewer

Existing Foul Sewer

Existing Storm Sewer

Existing Other Sewer

Existing Combined Trunk Sewer

Existing Foul Trunk Sewer

Existing Storm Trunk Sewer

Existing Other Trunk Sewer

Existing Rising Mains

Existing SWO

Existing WwTP

Existing WwPS

Proposed Upgrades

Proposed SWO Upgrades

Proposed WwTP Upgrades

Proposed WwPS Upgrades

Proposed Offline Storage Station

Proposed Rising Mains

Proposed Network Upgrades

Infiltration Removal

Storm Separation

Development Networks

2030

2055

2080

Development Sites

2030

2055

2080

Upgrade Scenario label

2030

2055

2080



Source:  
© Crown copyright and database rights 2025 Ordnance Survey 10018341  
Contains public sector information licensed under the Open Government Licence v3.0;  
Esri, Intermap, NASA, NGA, USGS, Sources: Esri, TomTom, Garmin, FAO, NOAA, USGS, © OpenStreetMap contributors, and the GIS User Community

01	7/18/2025	Initial Issue	PM	JL	AM	PM
Rev.	Date	Purpose of revision	Drawn	Check'd	Rev'd	Appr'd
Scale @ A3		Scale: 1:1,500			DO NOT SCALE	
Jacobs No. 321120AW						
<div><div>Jacobs</div><div>Merrion House, Merrion Road, Dublin 4, D04R2C5, Ireland Tel: +353 (0)1 269 5666 www.jacobs.com</div></div>						
Client <div><div>Uisce Éireann</div><div>Irish Water</div></div>						
Project <div>Cork Wastewater Strategy</div>						
Drawing Title <div>Courtbrack Proposed Upgrades for 2030, 2055 and 2080</div>						
Drawing Status <div>DRAFT</div>						
Drawing No. <div>321120AW/03/WW Modelling Docs/Optioneering/Courtbrack Figure 1</div>						
<p>© Copyright 2025 Jacobs Engineering Ireland Ltd. The concepts and information contained in this document are the property of Jacobs. Use or copying of this document in whole or in part without the written permission of Jacobs constitutes an infringement of copyright.</p> <p>Limitation: This drawing has been prepared on behalf of, and for the exclusive use of Jacobs' Client, and is subject to, and issued in accordance with, the provisions of the contract between Jacobs and the Client. Jacobs accepts no liability or responsibility whatsoever for, or in respect of, any use of, or reliance upon, this drawing by any third party.</p>						

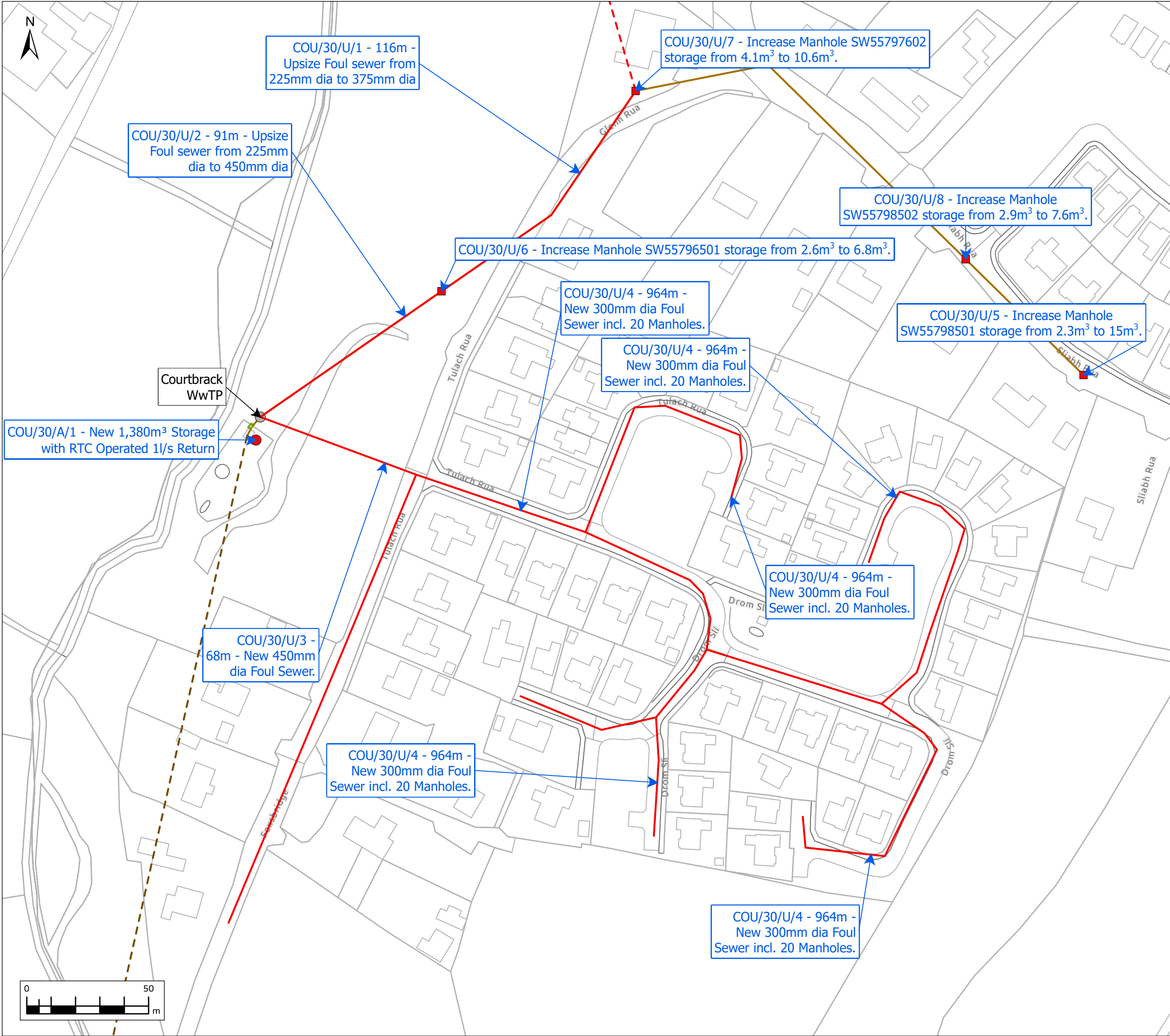

Figure 2

**Legend**

**Existing Network**

- Existing Combined Sewer
- Existing Foul Sewer
- Existing Storm Sewer
- Existing Other Sewer
- Existing Combined Trunk Sewer
- Existing Foul Trunk Sewer
- Existing Storm Trunk Sewer
- Existing Other Trunk Sewer
- Existing Rising Mains
- Existing SWO
- Existing WwTP
- Existing WwPS

**Proposed Upgrades**

- Proposed SWO Upgrades
- Proposed WwTP Upgrades

**Proposed WwPS Upgrades**

- Proposed Offline Storage Station
- Proposed Rising Mains
- Proposed Network Upgrades
- Infiltration Removal
- Storm Separation

**Development Networks**

- 2030
- 2055
- 2080

**Development Sites**

- 2030
- 2055
- 2080

**Upgrade Scenario label**

- 2030
- 2055
- 2080



Source:  
© Crown copyright and database rights 2025 Ordnance Survey 10018341  
Contains public sector information licensed under the Open Government Licence v3.0;  
Esri, CGIAR, USGS, Sources: Esri, TomTom, Garmin, FAO, NOAA, USGS, © OpenStreetMap contributors, and the GIS User Community

01	7/18/2025	Initial Issue	PM	JL	AM	PM
Rev.	Date	Purpose of revision	Drawn	Check'd	Rev'd	Appr'd

Scale @ A3: Scale: 1:1,500 DO NOT SCALE

Jacobs No. 321120AW

**Jacobs**

Merrion House, Merrion Road, Dublin 4, D04R2C5, Ireland  
Tel: +353 (0)1 269 5666  
www.jacobs.com

Client

**Uisce Éireann**  
Irish Water

Project

Cork Wastewater Strategy

Drawing Title

Courtbrack Proposed Upgrades for 2030, 2055 and 2080

Drawing Status

DRAFT

Drawing No.

321120AW/03/WW Modelling Docs/Optioneering/Courtbrack Figure 2

© Copyright 2025 Jacobs Engineering Ireland Ltd. The concepts and information contained in this document are the property of Jacobs. Use or copying of this document in whole or in part without the written permission of Jacobs constitutes an infringement of copyright.  
Limitation: This drawing has been prepared on behalf of, and for the exclusive use of Jacobs' Client, and is subject to, and issued in accordance with, the provisions of the contract between Jacobs and the Client. Jacobs accepts no liability or responsibility whatsoever for, or in respect of, any use of, or reliance upon, this drawing by any third party.