

Copyright  
 This drawing and any design here on is the copyright of the Consultants and must not be reproduced without their written consent.  
 All drawings remain the property of the Consultants.

THIS DRAWING TO BE READ IN CONJUNCTION WITH ALL RELEVANT ARCHITECTS AND ENGINEERS DRAWINGS.

FIGURED DIMENSIONS ONLY TO BE TAKEN FROM THIS DRAWING.

ALL LEVELS ARE IN METRES AND RELATE TO DATUM AT MALIN HEAD.

THIS DRAWING IS REPRODUCED FROM DIGITAL MAPS:  
 O.S. MAPS - Scale 1:2,500  
 O.S. MAPS - Scale 1:1,000  
 DISCOVERY SERIES - Scale 1:50,000

ALL MAPS ARE REFERENCED TO IRISH NATIONAL GRID (I.T.M.)

REPRODUCED FROM THE ORDNANCE SURVEY OF IRELAND BY PERMISSION OF THE GOVERNMENT. LICENSE NO. 3-3-34.

THIS DRAWING IS A COPY OF AN ELECTRONIC FILE AND IS COPYRIGHT.

ALL DIMENSIONS TO BE CHECKED ON SITE.

ALL MATERIALS AND WORKMANSHIP TO BE IN ACCORDANCE WITH ENGINEERS SPECIFICATION.

IT IS THE CONTRACTORS RESPONSIBILITY TO VERIFY ALL DIMENSIONS AND LEVELS PRIOR TO COMMENCEMENT OF CONSTRUCTION.

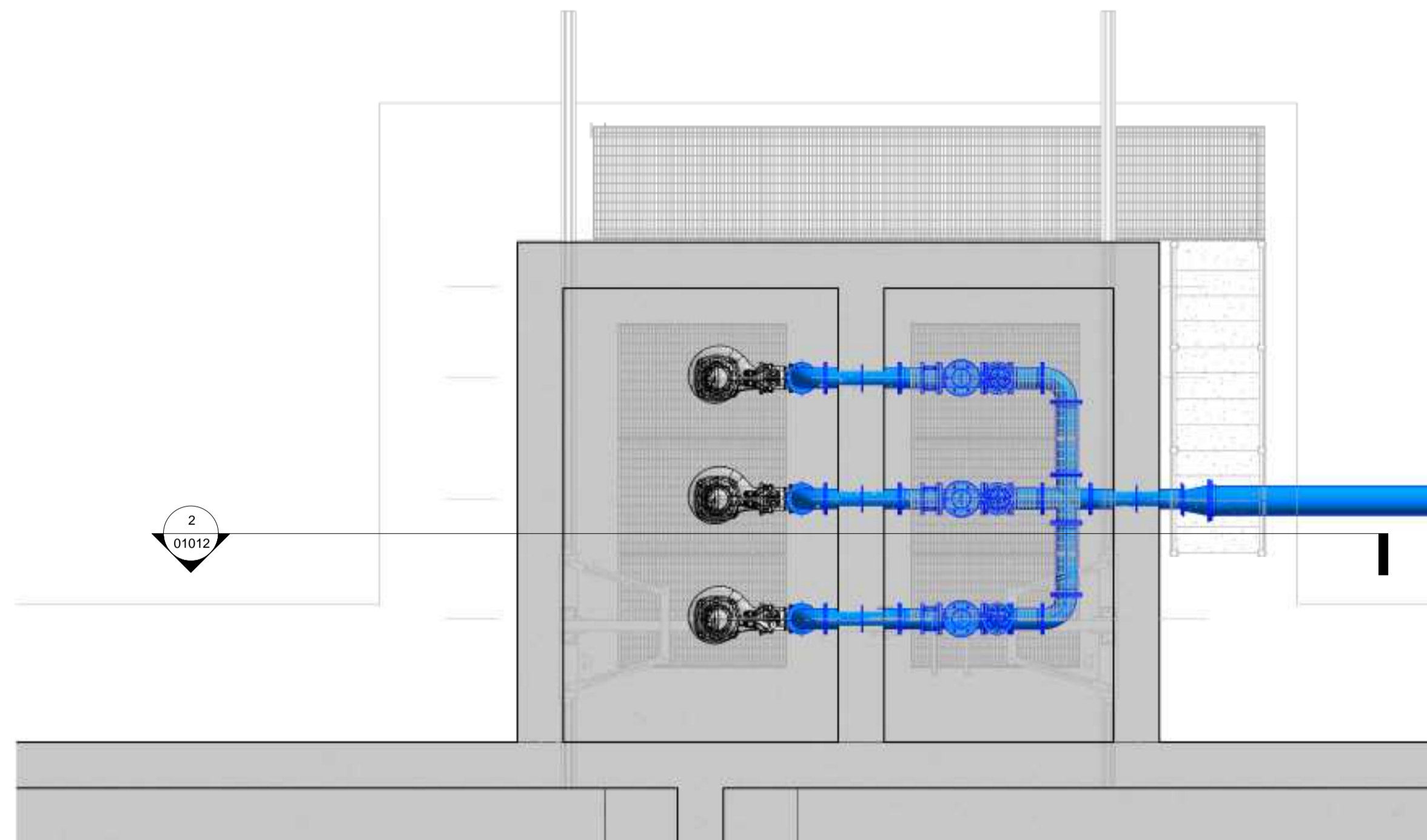

**1 Return Storm Pump Station Sump**  
 1 : 50

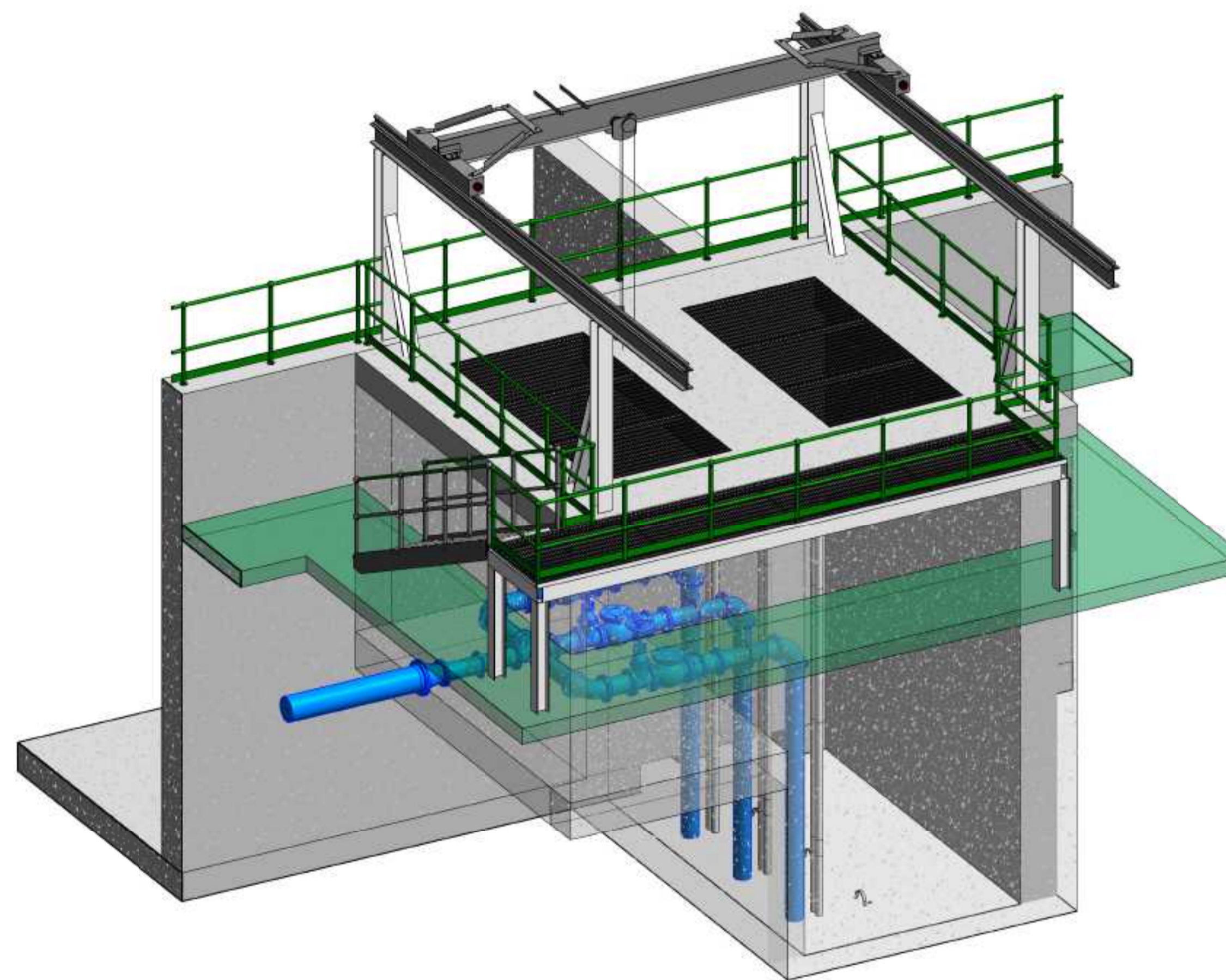

**3 3D OVERALL VIEW-PUMP SUMP**

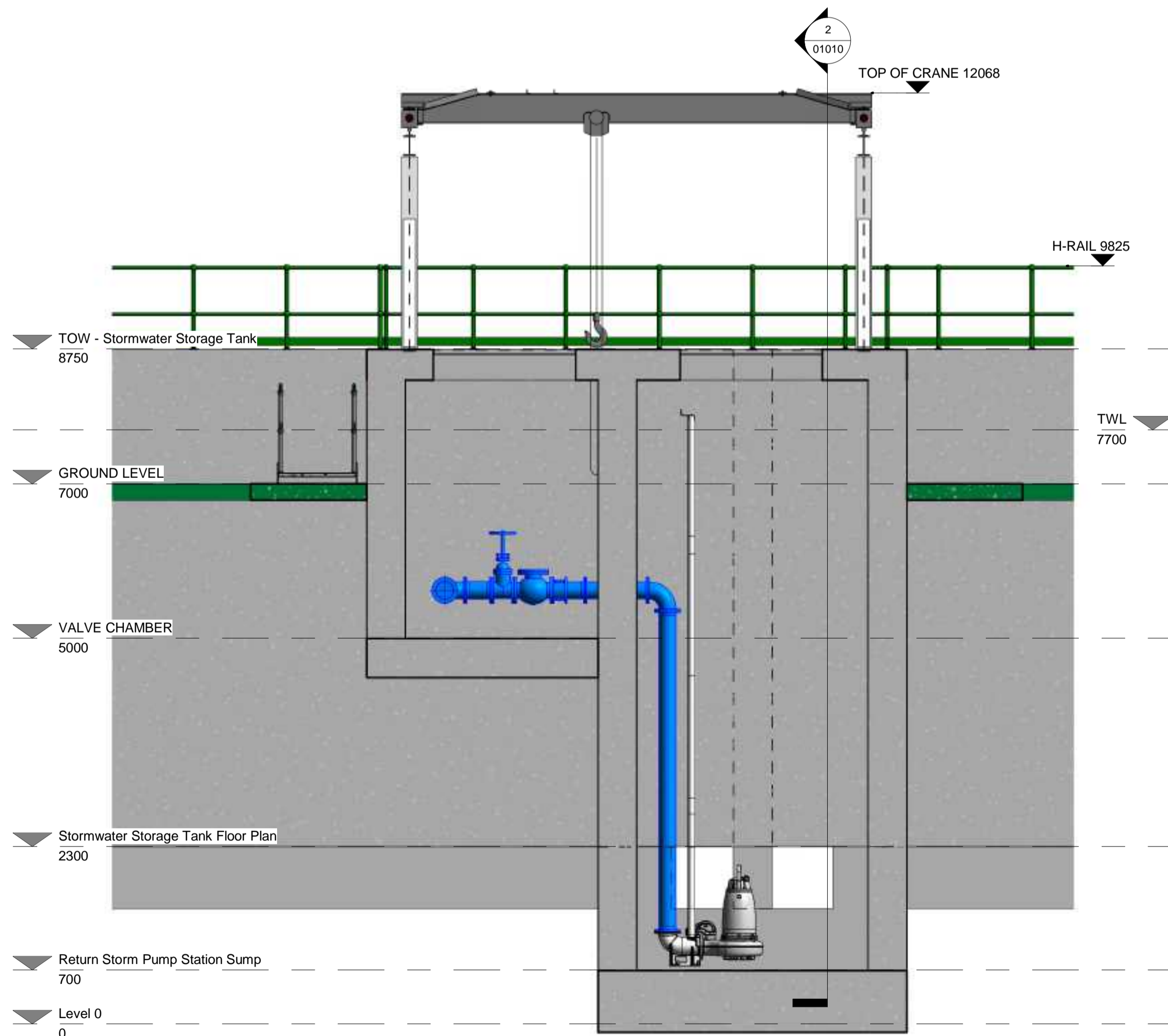

**2 Section 3**  
 1 : 50

C01	A1	ISSUED FOR PLANNING	PJ	28-02-23
Rev:	Suit:	Revision Description	Checked:	Date:

Client:

<b>UISCE</b> EIREANN IRISH WATER	Colville House 24-26 Talbot St Dublin 1	Tel: 1890 276 278 Int: +353-1-707 2828 email: info@water.ie Web: www.water.ie
-------------------------------------	---	--

Project:

**CASTLETROY WASTEWATER TREATMENT PLANT**

Clients Representative:

**J. B. Barry and Partners Limited**  
 Consulting Engineers

Classon House Dundrum Business Park Dundrum Road Dublin 14	Tel: +353 1 485 1400 email: info@jbbarry.ie web: www.jbbarry.ie	
---	---	--

Drawn By:	LHA	Date:	06/12/22
Checked By:	PH	Date:	06/12/22
Approved by:	PJ	Date:	06/12/22
Internal Project No.	20701-JBB-00-XX-DR-Z	Stage	PLANNING

Drawing Title:

**PROPOSED STORMWATER STORAGE TANK AND RETURN PUMP STATION PLAN AND SECTIONS**

Scales: 1 : 50

Drawing No.	Sheet No.	Revision:	Suitability:
20701-JBB-00-XX-DR-Z	01012	C01	